

23

24

25

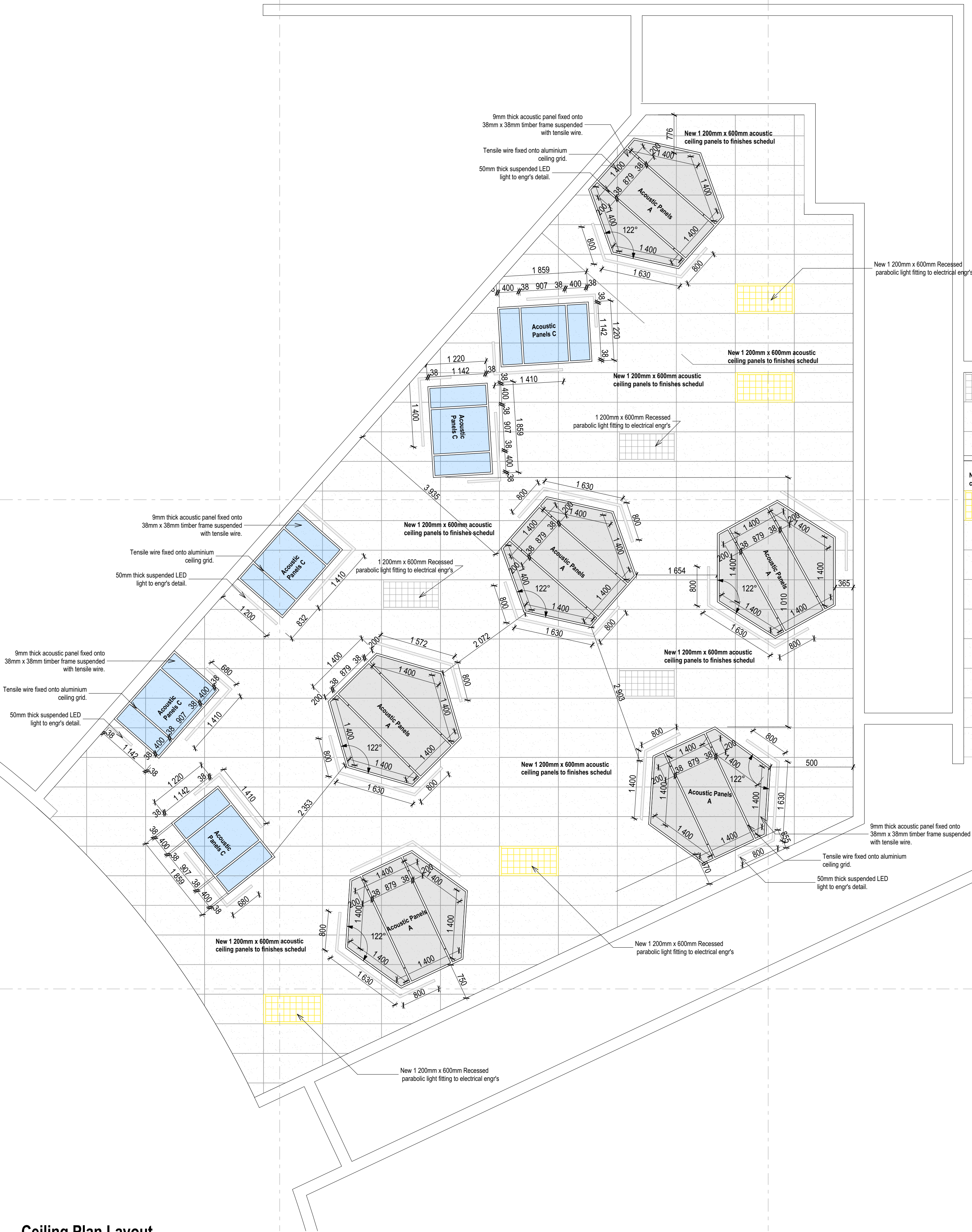

Ceiling Plan Layout  
Scale 1:50

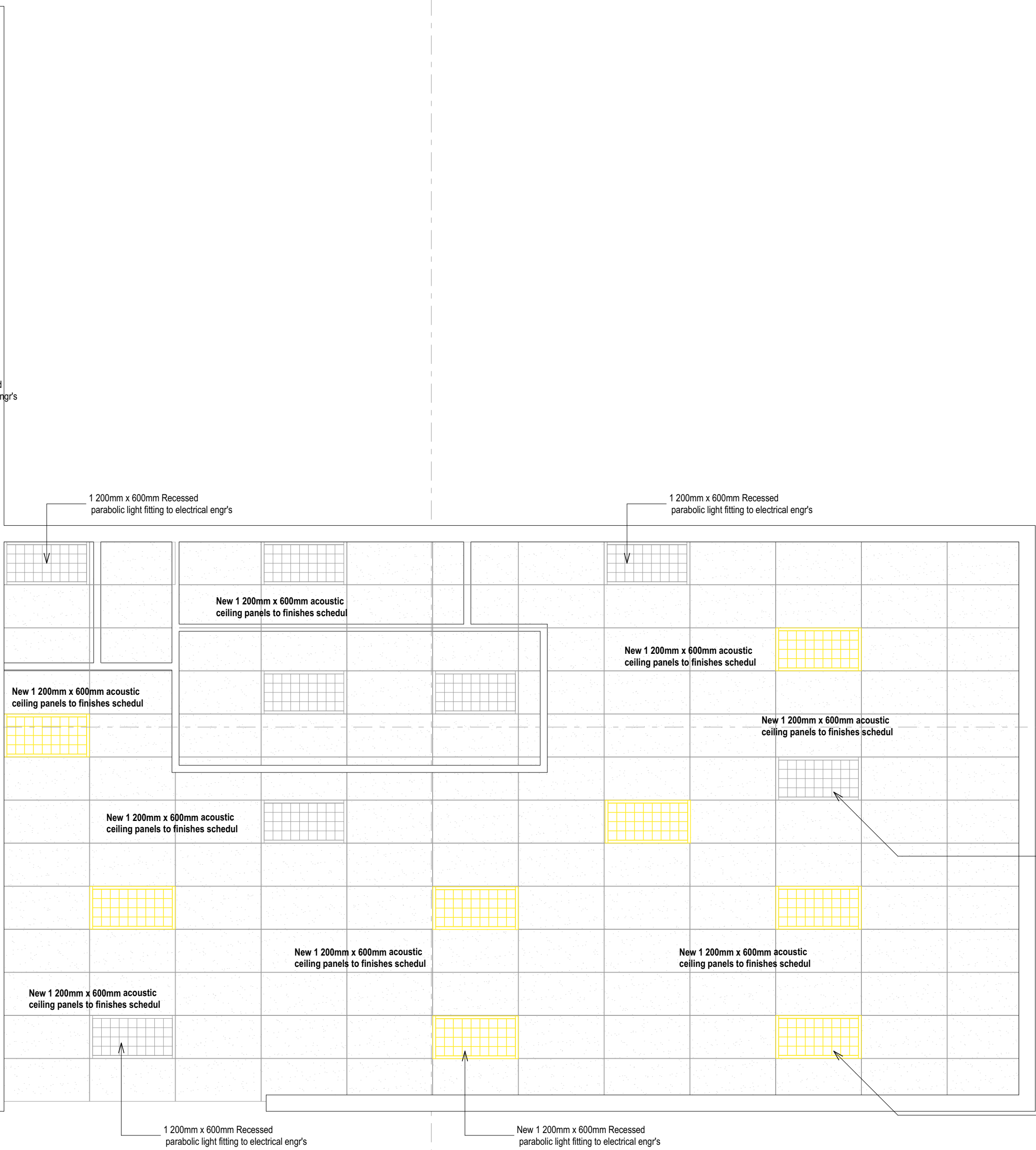

SYMBOL	DESCRIPTION	QUANTITY
	1 400mm x 38mm thick hexagon acoustic panels, colour to client's approval.	6
	830mm x 38mm thick hexagon acoustic panels, colour to client's approval.	5
	1 220mm x 1 860mm x 38mm thick rectangular acoustic panels, colour to client's approval.	11
	1 800mm x 800mm x 38mm thick trapezium acoustic panels, colour to client's approval.	5
	New 1 200mm x 600mm acoustic ceiling panels.	305.5m <sup>2</sup>
	Suspended LED linear light to electrical engr's detail.	
	1 200mm x 600mm Recessed parabolic light fitting	11
	New 1 200mm x 600mm Recessed parabolic light fitting	12

COPYRIGHT

In accordance with the relevant clauses of the Copyright Act (Act 98 of 1978) relating to assignment, all documents prepared by Celankobe in connection with the project remain the property and copyright of Celankobe, subject to their use by the client for the particular project to which this document relates, and the client shall not be entitled, either directly or indirectly, to make use of the document(s) for any additional or similar works or publish the same except with the prior consent from Celankobe

GENERAL NOTES

- All general notes apply to all drawings, details, specifications & any supplementary information: all contractual documentation.
- The contractor is responsible for checking all levels & dimensions on site when setting out, prior to commencing construction & cross checking all building dimensions during the construction process. Read only figured dimensions, indicated in millimetres, & do not scale. Any discrepancies are to be reported in writing to Celankobe prior to continuation of work.
- The contractor is responsible for the works co-ordination & programming of the works. All consultant & shop drawings are to be cross checked with Celankobe drawings. Any discrepancies are to be reported in writing to Celankobe prior to continuation of work.
- The contractor is responsible for reporting any deviation from Celankobe drawings & specifications. Written approval is required from ediff design prior to construction & installation commencing.
- Celankobe accepts no responsibility for errors resulting from the misinterpretation of drawings or specifications. If in doubt, query details.
- The contractor is responsible for: compliance with all applicable SABS 0400 standards, manufacturer's installation instructions, procedures & recommendations & local authority regulations in respect of the full scope of the works. This requirement shall not be deemed to be superseded by the provisions of any other contract document.
- The contractor is responsible for construction procedures & methodology being carried out & implemented in strict accordance with the latest occupational health & safety act & regulations.
- The contractor is responsible for checking all opening sizes & vertical & horizontal position prior to the construction, manufacture & installation of fitted items. Any discrepancies are to be reported in writing to Celankobe prior to continuation of work.
- The contractor is responsible for the provision of guarantees for all materials, installations & systems, to be issued to Celankobe at practical completion.
- All structural work is to be designed, detailed, specified & supervised by the structural engineer & is to be carried out in strict accordance with this. All structural work is to be built from the engineer's drawings and the stability is to be certified by the structural engineer on completion of the works.
- Drawings are only to be read for the purpose intended.
- Refer to project data sheet for comprehensive notes & specifications.

REVISION

- All Acoustic panels and linear LED light in the back office are removed.
- There is an addition of 12, 1 200mm x 600mm recessed lights both in the back and front office.
- Acoustic panels and some linear LED light in the S.S.T. Operational Manager, Service pod 5 & Break Room in the front office are removed.

KEY PLAN

CENTURION T: +27 87132000 F: +27 814884295	
57 MAHONIE, DORINGKLOOF, CENTURION	
PROJECT TITLE	
PROPOSED SARS RANDFONTEIN OFFICES RANDFONTEIN, TAMBOTIE MALL	
CLIENT	
SOUTH AFRICAN REVENUE AUTHORITY SERVICES (SARS)	
THE SIGNATURE HERETO CONFIRMS THAT THE SIGNATORY HAS INSPECTED THE PLANS AND IS AUTHORISED TO ACCEPT & APPROVE THEM ENTIRELY	
SIGN	DATE
DATE	03/08/2024
DRAWN	SD
CHECKED	T. THOMO
SCALE	SCALE 1:50
RESPONSIBLE PROFESSIONAL	
THEMBA THOMO	
PR NUMBER	R1294
SHEET NUMBER	04
DATE	
SIZE	DRAWING NO
JOB NO	STAGE
ZONE	SERIES
FAMILY	REVISION

TENDER DRAWINGS

A1 SARSRF\_ARCL\_003\_00\_T 01